



DELUXE PICATINNY & SWIVEL STUD MOUNT
FOLDABLE BIPOD
TACTICAL LOW-PROFILE

- ▶ High Tech Durable Aluminum Construction
- ▶ Clever Picatinny and Swivel Stud Mounting Systems
- ▶ Unique Posi-Lock Feature to Prevent Tipping
- ▶ Panning with Fully Adjustable Center Height From 9" to 11"



Press Down to Fold/Unfold Legs



Posi-Lock Feature to Prevent Tipping



TL-BP69ST



Twist to Lock/Unlock for Leg Length Adjustment



Swivel Stud Mount



Picatinny Mount

SWIVEL STUD MOUNT

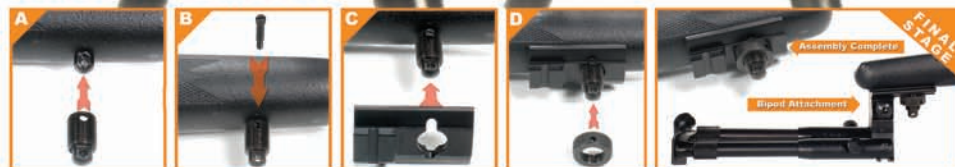

REVERSIBLE STEEL STAND



Unscrew the cinch lock and separate the extension leg from the bipod.



Switch the left and the right extension legs.



Rotate both steel stands with a 180 degree turn.



Align and insert the head of the extension leg into the bipod upper leg and secure the cinch lock.